

MiniTech



Eigenschappen

Toetsenbord

- Scherm 2x16 regels
- 10 Alpha-numerieke druktoetsen
- 2 Functietoetsen
- Toetsenbord test
- Automatische winter-/zomertijd
- Geluidsignaal
- LED groen / rood
- Batterij compartiment
- Dallas sleutellezer
- Voeding:
 - Alcaline 9 V batterij
 - Grote batterijbox
 - Vaste voeding

Sloten

- Master code
- Manager code
- 10 Transporteerscodes
- 48 Gebruikers codes
- Eenmalige codes
- Meer sloten systeem
- Openingsvertraging 1-99 minuten
- Openvenster 1-19 minuten
- Dallas sleutels
- Stil alarm
- Blokkeren opening op afstand
- Omzeilen vertraging op afstand
- Straftijd
- 4-Ogen principe
- Tijd-programma
- Openings- en sluit periodes
- Onmiddellijke sluiting
- Tijdelijke sluiting
- Audit met datum en tijd (tot 5500 gebeurtenissen)



RotoBolt



StraightBolt



SpringBolt



MotorLock



Motor SpringBolt

MiniTech

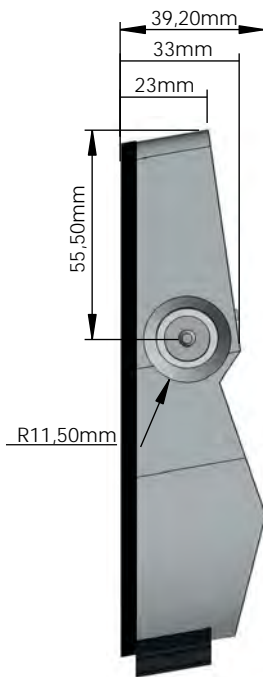
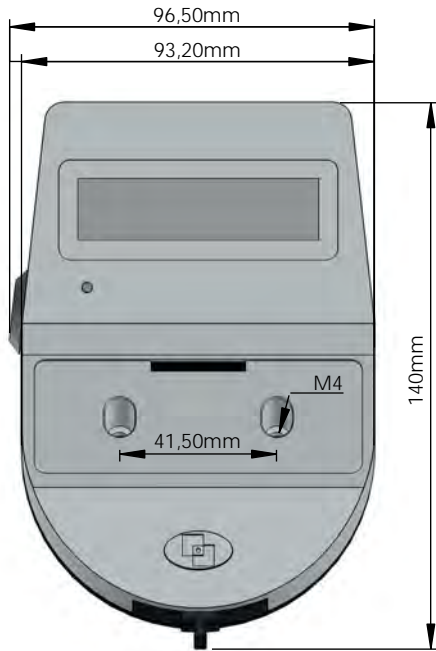

RotoBolt

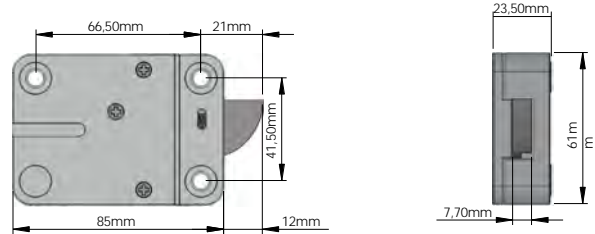

StraightBolt

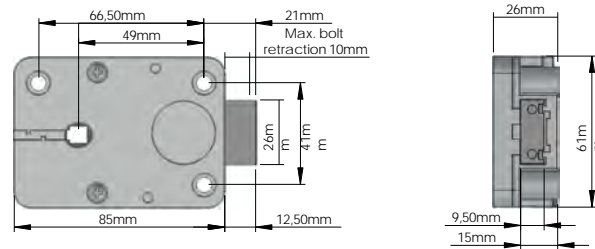

SpringBolt

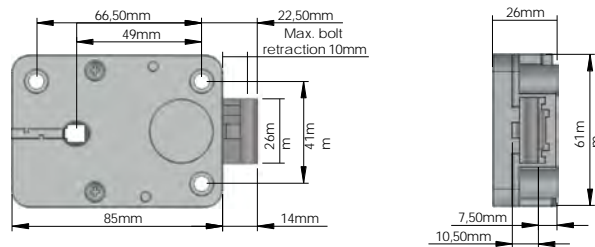

MotorLock

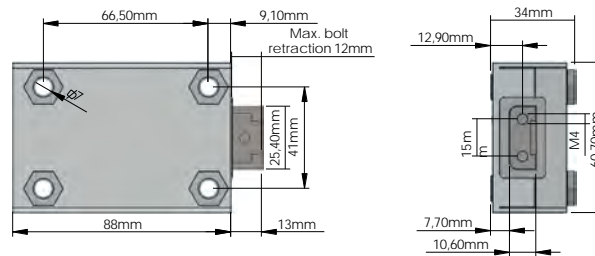

Motor SpringBolt

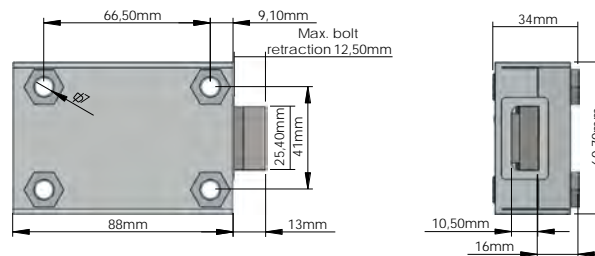

GLOBAL HEADQUARTERS

Tecnosicurezza
Via C. Battisti, 276
37057 S.Giovanni Lup.(VR)
ITALY
info@tecnosicurezza.it
www.tecnosicurezza.it

USA HEADQUARTERS

Tecnosicurezza
50, Thomas Lane
Versailles, KY 40383
USA
info@usatecno.com
www.usatecno.com

SPAIN HEADQUARTERS

Tecnosicurezza
C/Menor, 4 - Nave I0, Pol Ind. "La Mina"
28770 Colmenar Viejo
SPAIN
info@tecnosicurezza.es
www.tecnosicurezza.es